

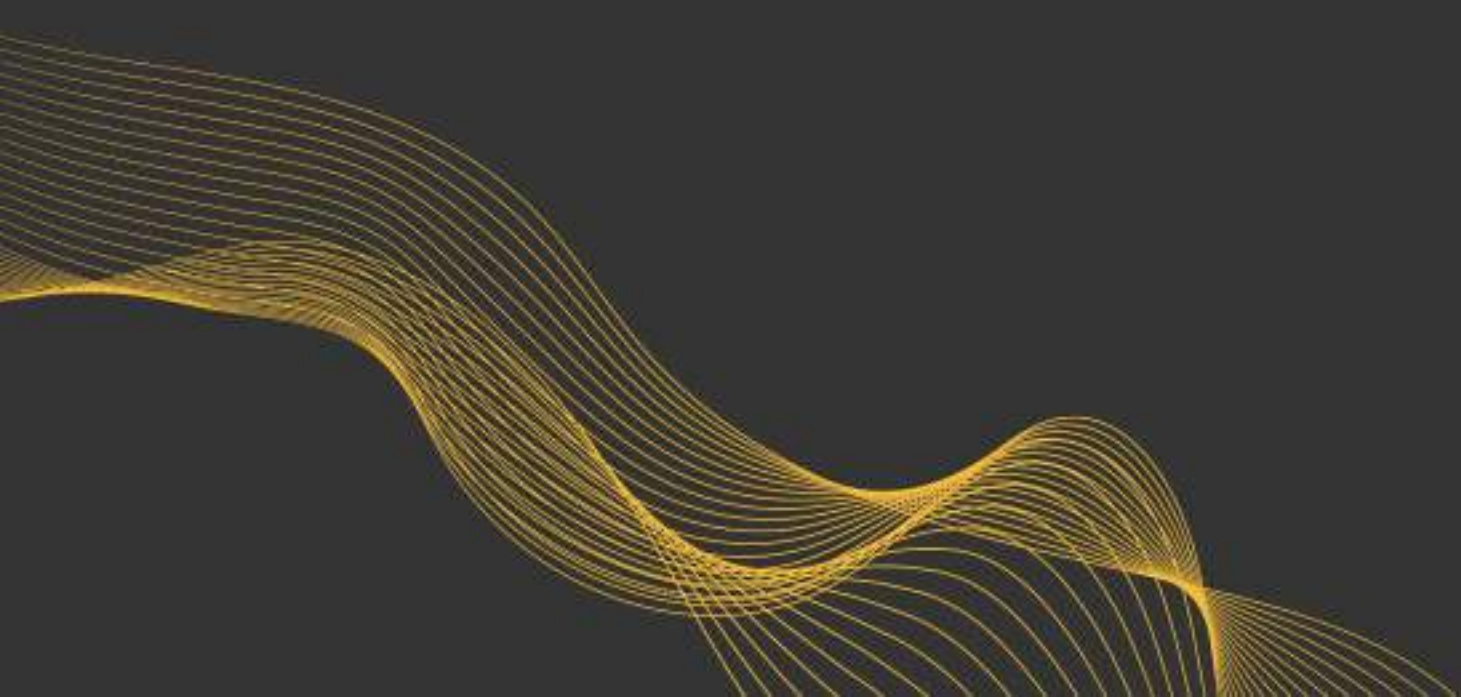

COLLECTION

2022





Hello!

The idea is what brings change and diversity, that's what we believe in and started this journey of emerging greatness with innovation in ceramic world. With trust that we received from earlier stages, comes responsibility of giving the best in quality. We are now a large scale manufacturer, satisfying need of uniqueness to the clients and exporting to those who wish for getting not the ordinary; but the class.

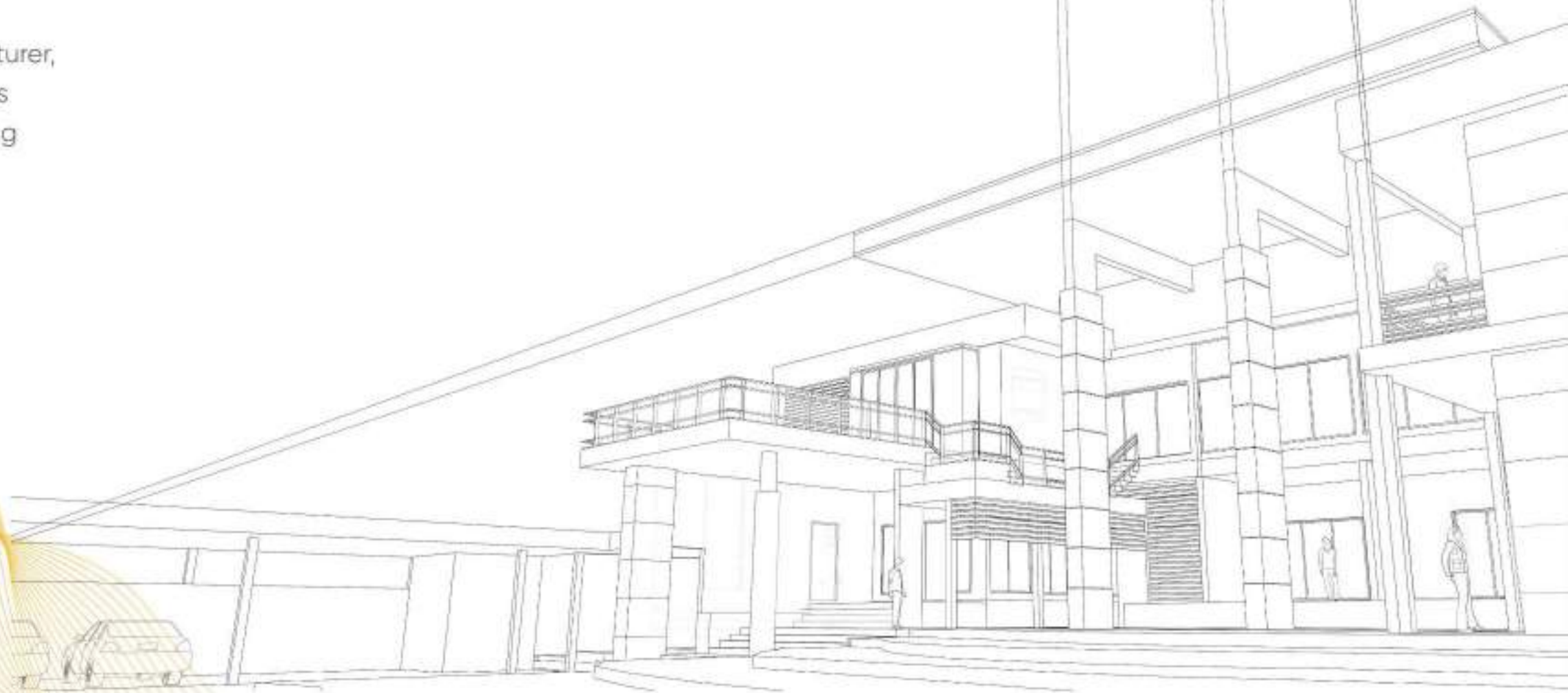



VISION

Sword group aims to be the fastest growing manufacturing organization in india with the focus on continuous and valuable innovations. Subsequently, create its irrefutable presence amongst the premium brands on a global scale.



MISSION

To make sure that each tile produced in our factory reflects individuality and beauty of natural stone, right down to subtle differences in tone, texture and that it reaches every corner of the world.



OUR VALUES

Quality

Creating enchanting never runs for long if not given the solid make for it's inside Beauty. That's what we are specialized for every products sword comes with committed durability and long lasting Impression of its Newness.

Eco Friendly

Though the products are resistant to all difficult natural conditions, It doesn't cause any harm to any natural gifts of this world. machines are serviced every now and then - to lower the chances of damage for the matter of ecological balance.

Technologies

Accepting the new, brings more legacy to Existing greatness for our ceramic Series. Technologies an Techniques, we have gathered from all over the world's best new gen concepts, delivers perfection only.



GVT & PGVT

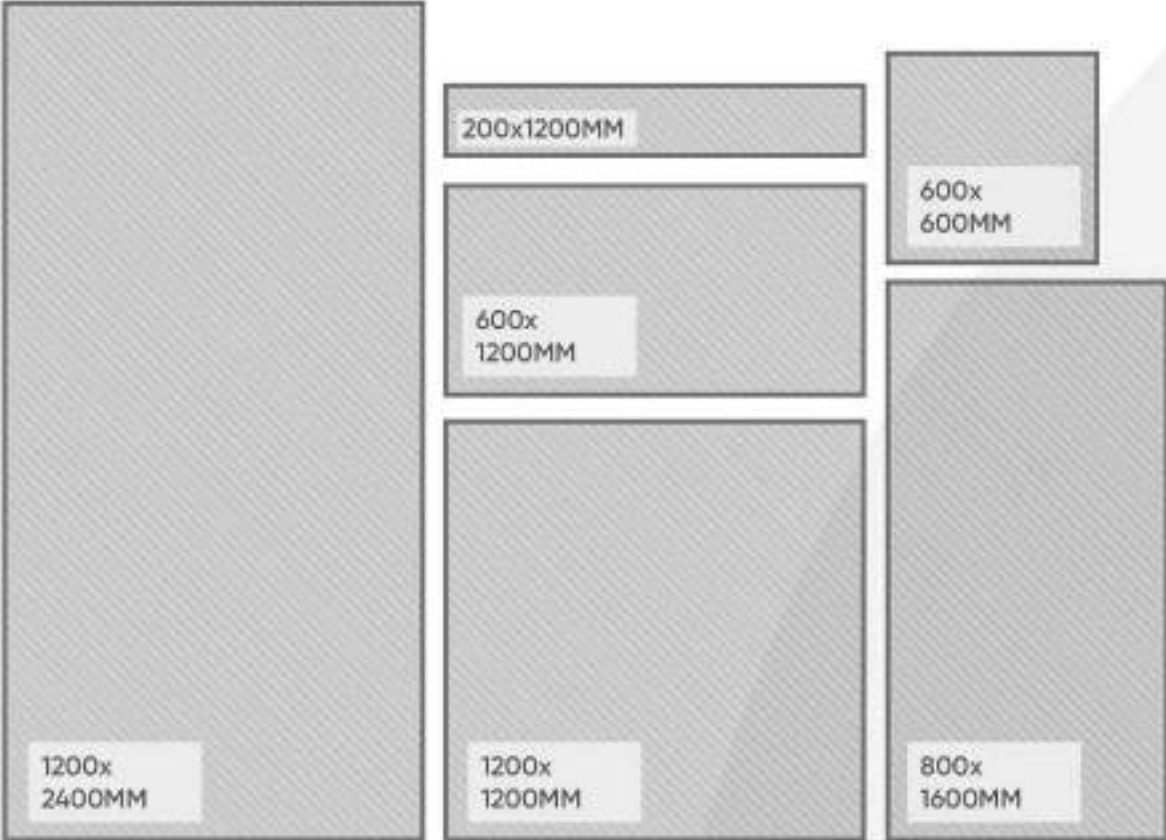

WALL TILES

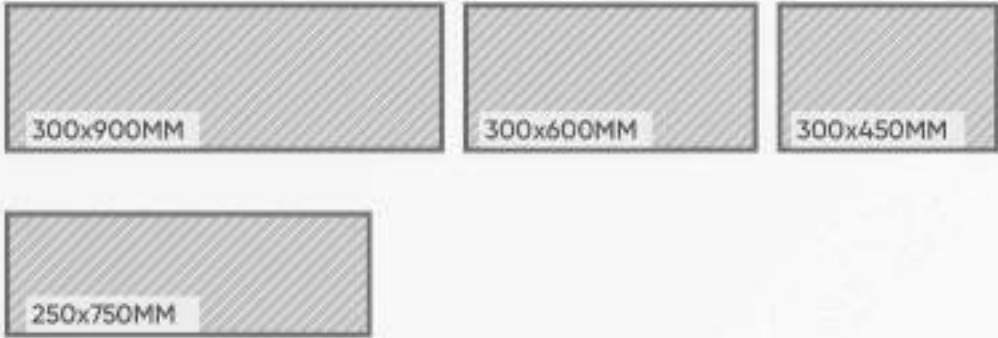

FULLBODY SLAB



PARKING TILES





EXPORT

Having ready resolutions for every order from around the world, we have never said no in any circumstances to any valuable client. Realised of our responsibility and expected responses from us, our delivery is safe as well as convenient to give a satisfying experience. Expanded to many countries, Sword has a separate agency to look into the matter of international relations and supporting clients of foreign states. Even the distributors and dealers are located at different outside places in case of any physical support.

OUR NETWORK

Africa · Albania · Algeria · Australia · Bahrain · Belgium · Guatemala · Iraq · Ireland · Israel · Kuwait · Lebanon · Libya · Malta · Mauritania · Palestine · Peru · Poland · Romania · Spain



WHY SWORD



Since our inception we have remained at the forefront of cutting-edge design and quality.



Largest Exporter since last 4 consecutive years, No. 1 in Ceramic Export.



Among the Top 10 ceramic brands of India & the youngest in the market.



Penetration in over 25+ countries apart from India.



Our World Class Production Facility using the latest machinery & equipments.



Well-built Network of all showrooms throughout the country.



45 Million sqm. High-end and extremely efficient production units.



Size & Thickness

C
INTENSE COLOR

800x
1600mm
Size

◀▶
09mm
Thickness

Available Series



A



B



C



D



E

A

GLOSSY
MARBLE

B

HIGHGLOSS
MARBLE

C

MATT
MARBLE

D

CARVING
MARBLE

E

SUPER WHITE
MARBLE

800x1600MM | 32"x64"

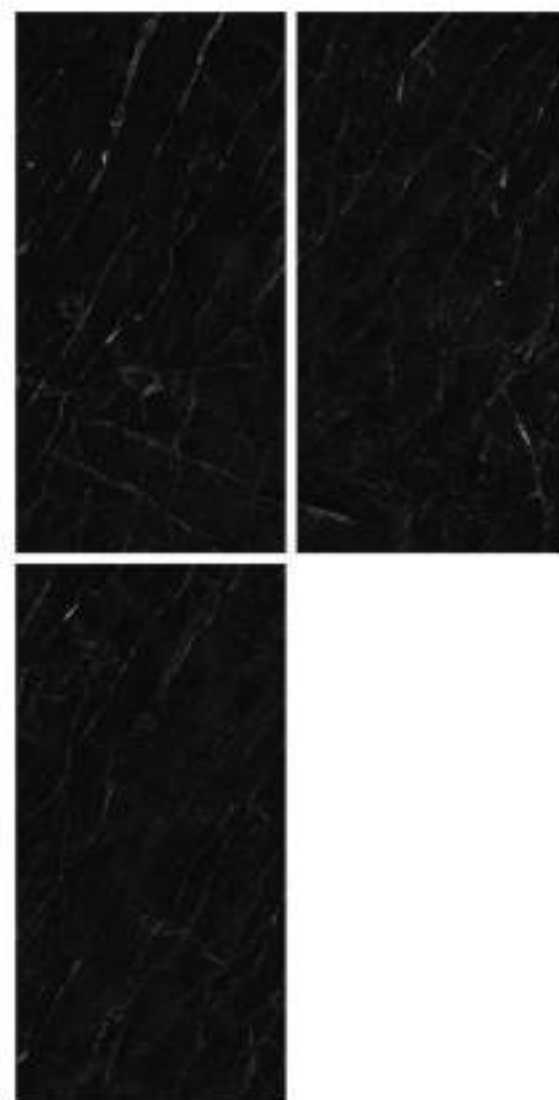
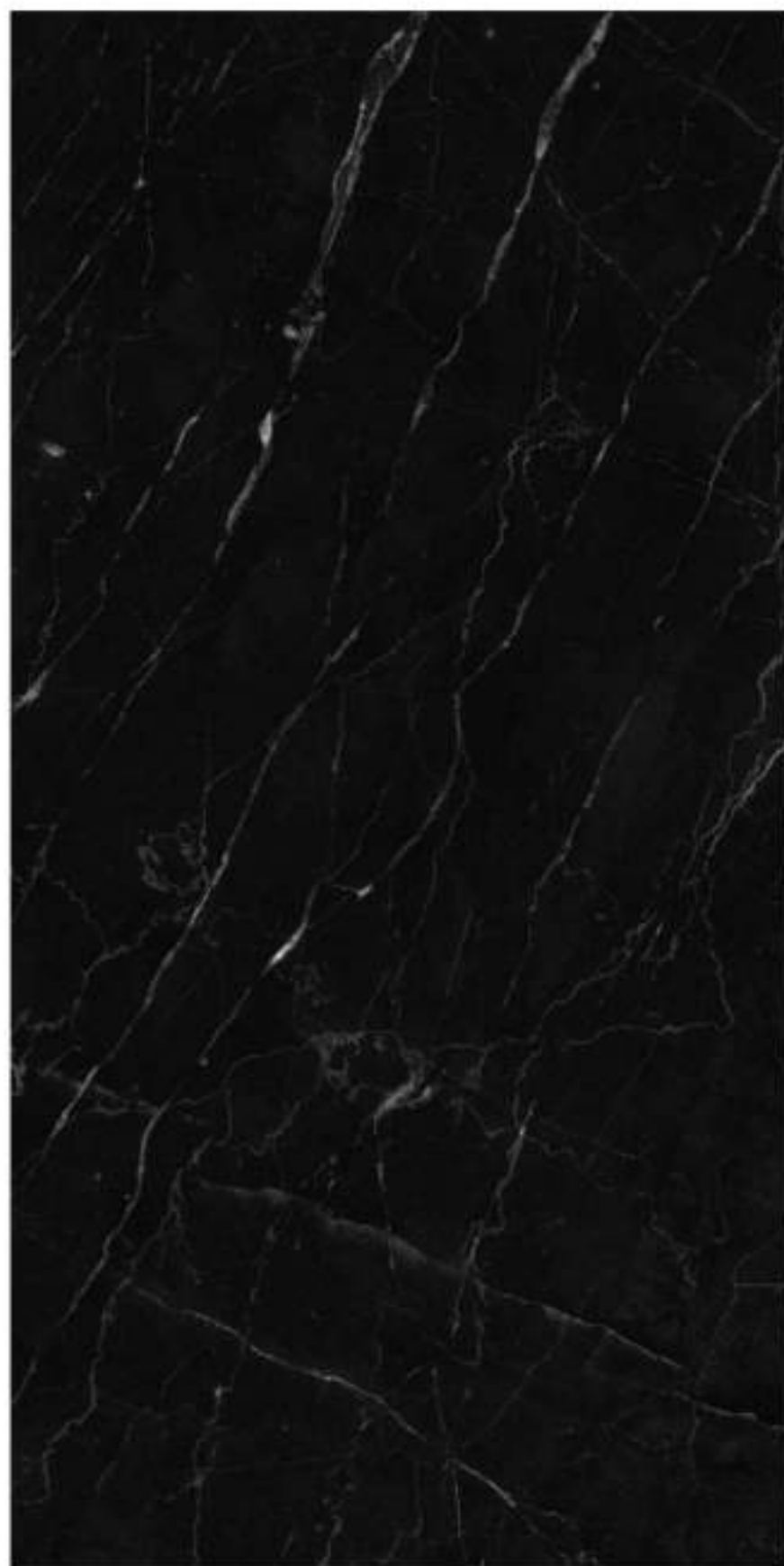

MARBLE TOUCH
next level slab

**ETERNAL
BLACK**

Finish | High Gloss +
Random | 3 Faces

MARBLE TOUCH
next level slab

**NOIR
BLACK**

Finish | High Gloss +
Random | 3 Faces

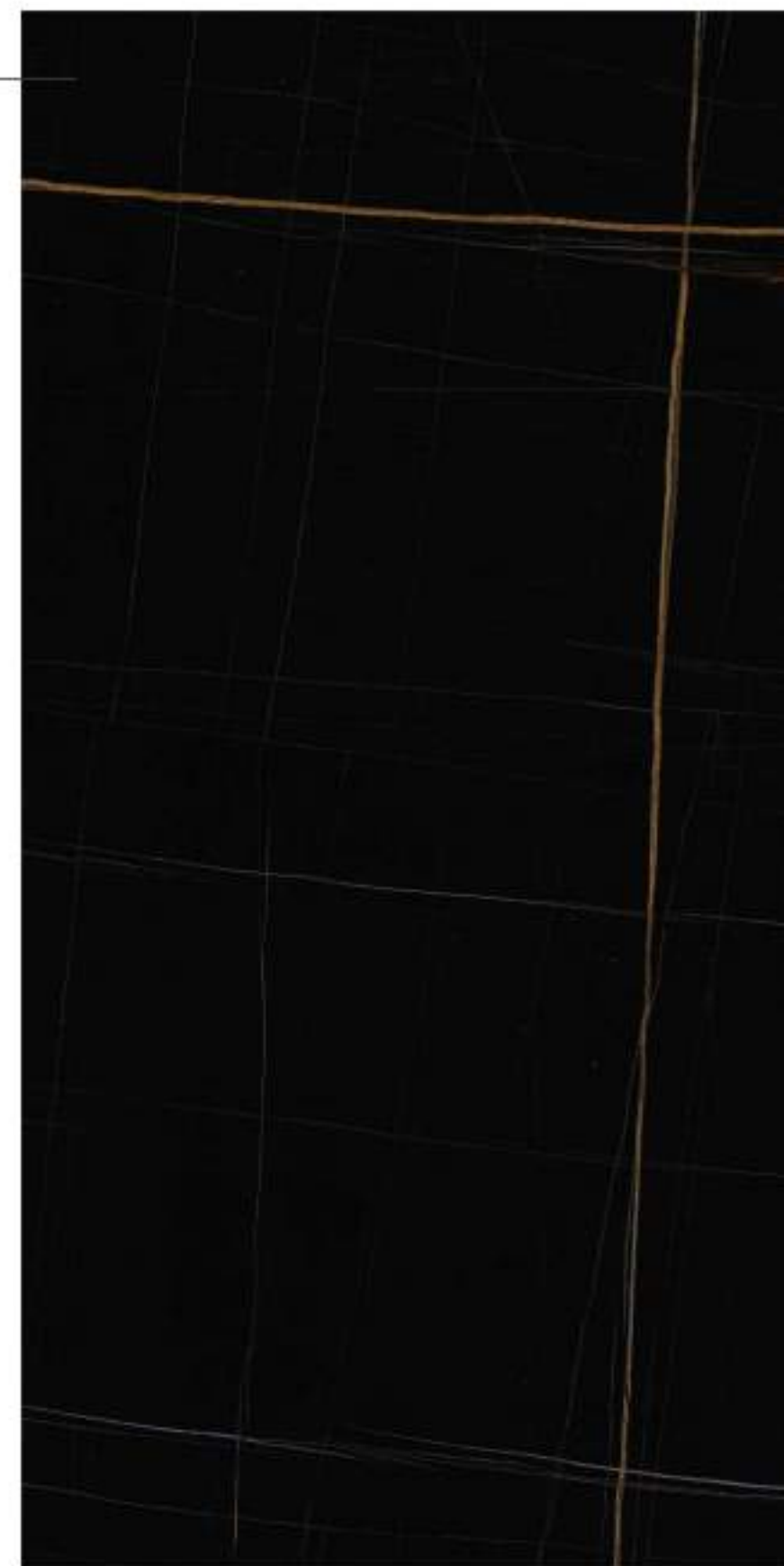



800x1600MM | 32"x64"



MARBLE TOUCH
next level slab

**PIETRA
BLACK**

Finish | High Gloss +
Random | 4 Faces

MARBLE TOUCH
next level slab

**CALACATA
BLACK**

Finish | High Gloss +
Random | 4 Faces

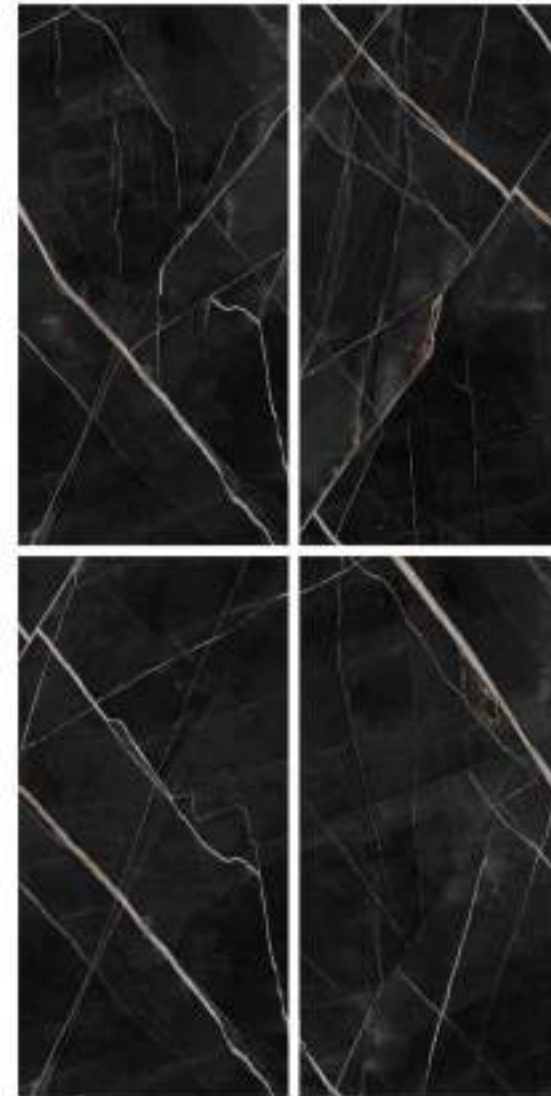

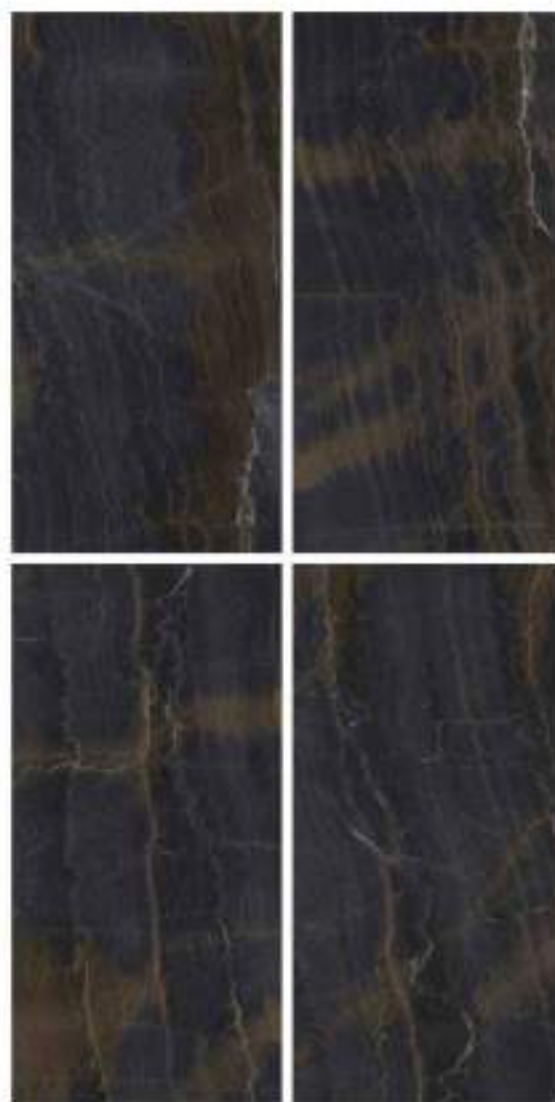

MARBLE TOUCH
next level slab

**MILOS
BLUE**

Finish | High Gloss +
Random | 4 Faces

MARBLE TOUCH
next level slab

**LAPONIA
NEGRO**

Finish | High Gloss +
Random | 4 Faces

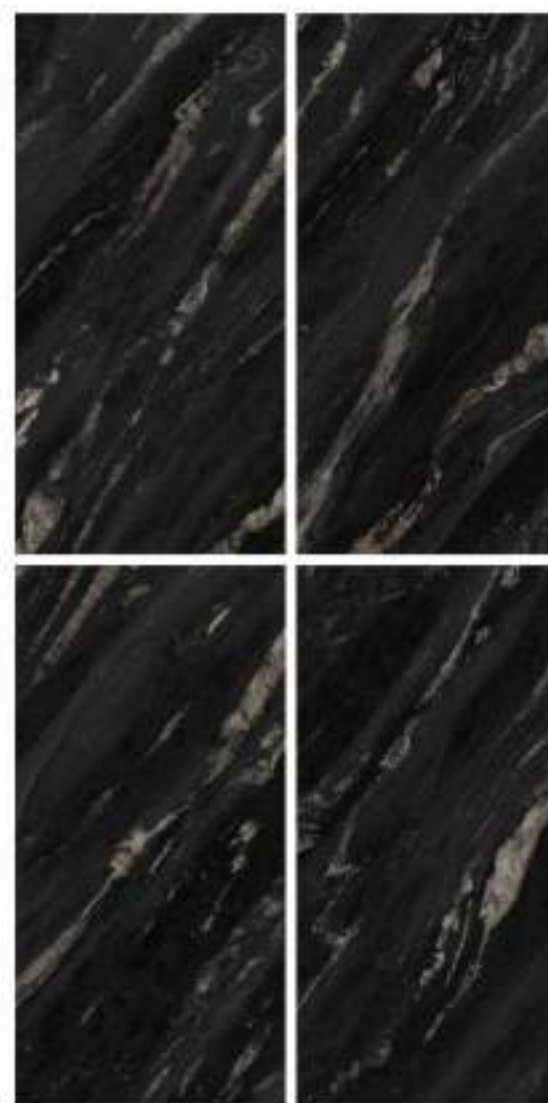



800x1600MM | 32"X64"

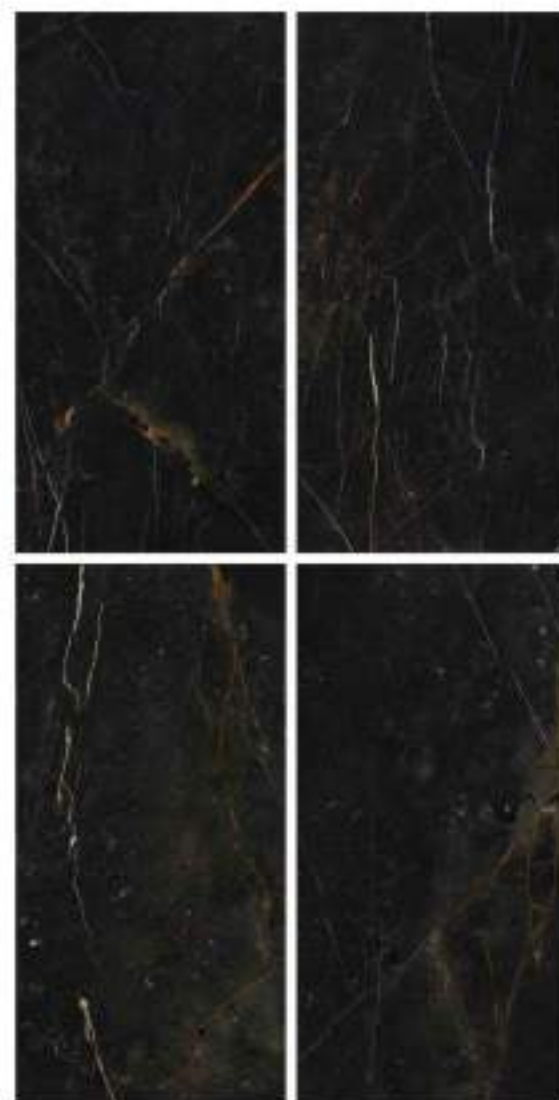

MARBLE TOUCH
next level slab

**SAINT
PORTO BLACK**

Finish | High Gloss +
Random | 4 Faces

MARBLE TOUCH
next level slab

**VOLGA
BLUE**

Finish | High Gloss +
Random | 4 Faces

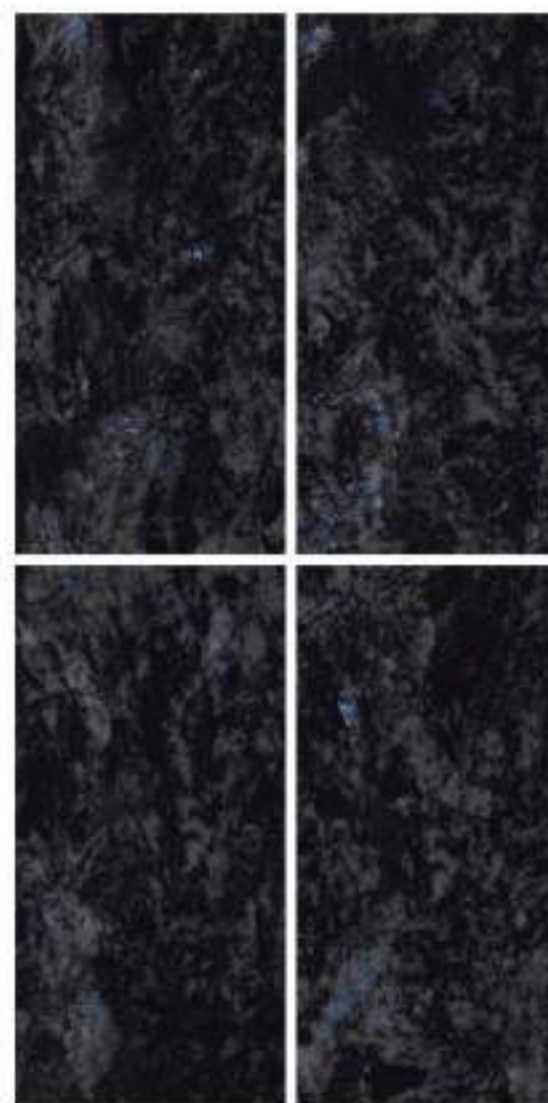

TECHNICAL SPECIFICATION

CHARACTERISTIC	STANDARD AS PER ISO-13006/EN14411 GROUP Bla	VALUE	TEST METHOD
REGULATORY PROPERTIES			
Deviation in length & width	±0.5 %	±0.1 %	ISO-10545-2
Deviation in thickness	±5.0 %	±4.0 %	ISO-10545-2
Straightness in side	±0.5 %	±0.1 %	ISO-10545-2
Rectangularity	±0.5 %	±0.1 %	ISO-10545-2
Surface flatness	±0.5 %	±0.2 %	ISO-10545-2
Color difference	Unaltered	No change	ISO-10545-16
Glossiness	As per mfg	Min 90%	GLOSSOMETER
STRUCTURAL PROPERTIES			
Water absorption	< 0.50 %	< 0.05 %	ISO-10545-3
Apparent density	> 2.0 g/cc	> 2.10 g/cc	DIN 51082
MASSIVE MECHANICAL PROPERTIES			
Modulus of rupture	Min. 35 N/mm ²	Min. 40 N/mm ²	ISO-10545-4
Breaking strength	Min. 1300 N	Min. 2000 N	ISO-10545-4
Impact resistance	As per mfg.	Min. 0.55	ISO-10545-5
SURFACE MECHANICAL PROPERTIES			
Surface abrasion resistance	As per mfg	Min. Class-3	ISO-10545-7
MOH's hardness	As per mfg	Min. 4	EN 101
THERMO HYGROMETRIC PROPERTIES			
Frost resistance	No damage	No damage	ISO-10545-12
Thermal shock resistance	No damage	No damage	ISO-10545-9
Moisture expansion	Nil	Nil	ISO-10545-10
Thermal expansion (COE)	Max. 9.0 x 10 ⁻⁶	Max. 6.5 x 10 ⁻⁶	ISO-10545-8
Crazing resistance	As per mfg	Min. 10 Cycle	ISO-10545-11
CHEMICAL PROPERTIES			
Chemical resistance	No damage	No damage	ISO-10545-13
Stain resistance	Resistant	Resistant	ISO-10545-14
SAFETY PROPERTIES			
Slip resistance	As per mfg	> 0.40	ISO-10545-17
Fire resistance	As per mfg	Fireproof	N. A.
Lead & Cadmium given off by glazed tiles	As per mfg	Does not yield Pb & Cd	ISO-10545-15

PACKING DETAILS

Size	Tiles / Box	Coverage Area / Box <small>(approx.)</small>	Coverage Area / Box <small>(approx.)</small>
80X160CM	2 pcs	2.56 Sq. m.	27.55 Sq. ft.

Note: Colour Shown are as accurate as the limitations of the printing process will allow. Prospective customers are advised to inspect a sample of the tile before ordering. Every effort has been made to ensure the accuracy of the information given. However, the company reserve the right to change the specifications without prior notice. Sometime variations in shade or size being inherent to ceramic industry may occur. Before fixing, we advise you to follow the fixing instructions on the cartons of the tiles as no responsibility can be accepted by the company once the tiles have been fixed.



 +91 96384 72778
+91 75750 03333

 swordintrl@gmail.com

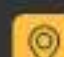
 109, Oreva Arcade, At.shiv Ajanta Hotel,
Morbi, Gujarat (363642).